

Example B



Accident

At 23.30 on 24 November 2006, a bus that was being driven by one of his colleagues hit 42-year-old Ted Simpson.

Ted had just parked his bus in a designated parking bay, carried out his end of shift checks and pushed his snack box, newspaper and hi-visibility jacket into his workbag. He then set off to the staff mess room to officially log out for the day and pick up his coat. Like every other day, instead of using the footpath around the site, Ted took the shortest route to the mess room, which meant crossing the bus lane. Unfortunately, as he turned to call good night to a colleague an incoming bus hit him. The driver, John, subsequently reported that he simply hadn't seen Ted. He had driven his bus into the depot and was concentrating on where to park; he swung the bus out wide, crossing the white markings, in order to drive it into the parking bay. He became aware of having hit 'something' and colleagues started shouting at him to stop.

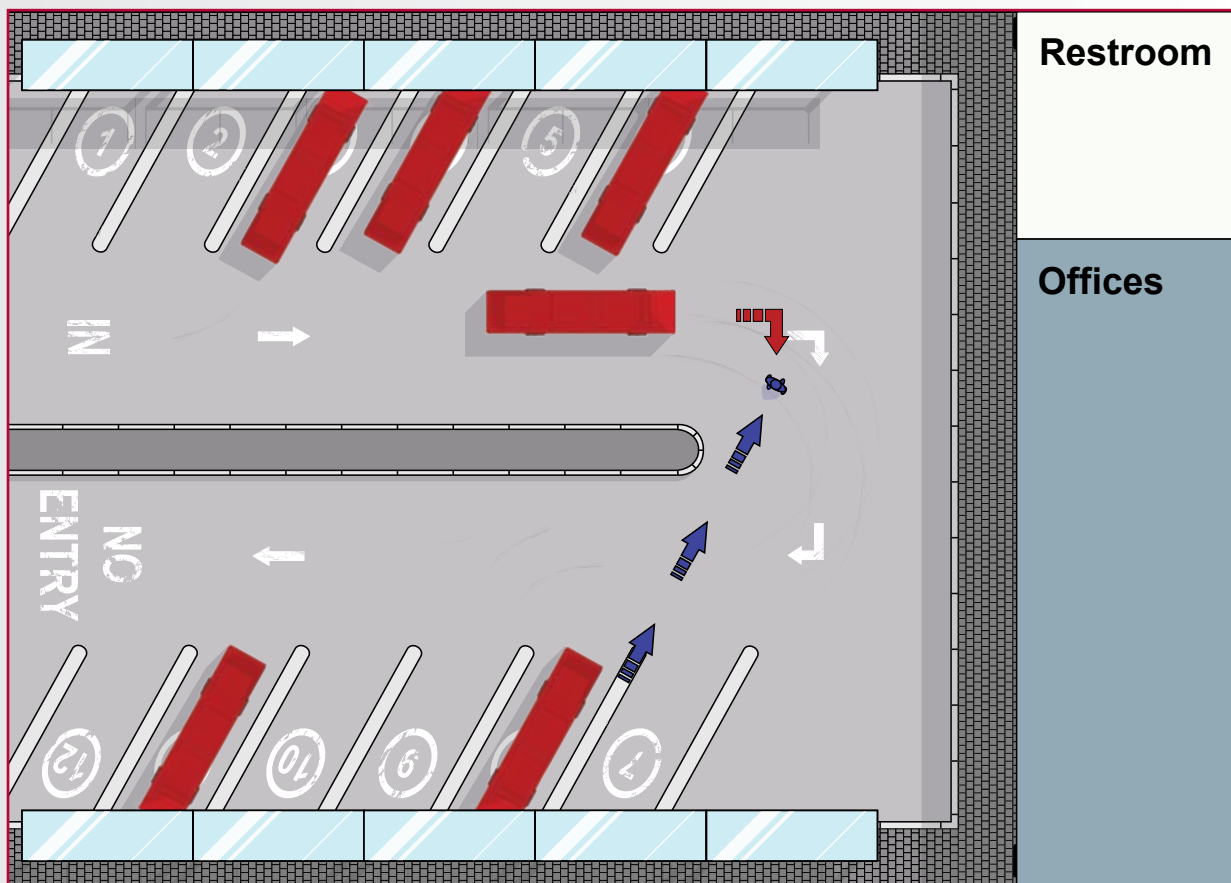

Example B

Site description

The accident happened at an indoor bus depot. There was a one-way system around the depot, with a separate entrance and exit for the buses. A block of white hatching was used to separate the bus routes and there were 10 designated parking bays.

The site had a mess room for staff meals, which also contained lockers for staff to store personal belongings and a 'clock' for logging on and off shift. The mess room was in the far corner of the depot and there was a footpath around the outside edge of the parking bays.

Minimal lighting was required in the depot as the vehicle lights were thought adequate for manoeuvring the buses.

The consequences

The injuries that were sustained by Ted were so severe that he had to have his right leg amputated below the knee. John was so traumatised by the event that he was unable to work for six months following the accident. The company was prosecuted by the Health and Safety Executive for breaching the Health and Safety at Work etc Act 1974, in that it failed to ensure the safety at work of employees, and specifically that the company did not control the risks posed by the movement of vehicles and pedestrians at the depot.

